

LOT
15

By order of The Court of Protection

64 Wills Crescent, Hounslow, Middlesex TW3 2JB

Guide Price £340,000*

THREE BEDROOM SEMI DETACHED HOUSE IN NEED OF UPDATING



The property is situated in a popular location within easy access of the centre of Whitton with its shopping facilities and main line train station. The centres of Hounslow and Twickenham are also within easy reach. Good road links serve the area including the M4 that connects to Central London, Heathrow London Airport and The West. The house is a three bedroom dwelling with two reception rooms and also benefits from a garage and a very spacious garden to the rear. The house is in need of complete updating and modernisation throughout. It is sold with full vacant possession and will be of interest to investment buyers and owner occupiers. **Please note that this lot will not be sold prior to auction under any circumstances. Any intending buyer will be required to register to bid at the auction.**

ACCOMMODATION

Porch, Entrance Hall, Lounge, Dining Rom, Kitchen, Landing, Bedroom one, Bedroom Two, Bedroom Three, Bathroom, Separate WC, Garage, Spacious Garden.

TENURE

Freehold

LOCAL AUTHORITY & TAX RATING

London Borough of Richmond Upon Thames
Council Tax Band D

VIEWING TIMES

Thursday 23rd March @ 11.30am – 12 noon Saturday 1st April @ 11am – 12 noon Wednesday 5th April @ 1.30pm – 2pm OPEN VIEWING SESSIONS – NO NEED TO BOOK IN

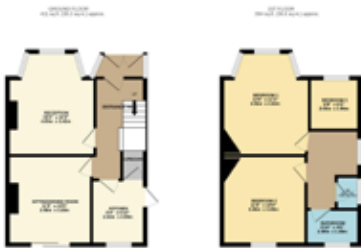

STARTING BID

FINAL BID

NOTES SOLD UNSOLD SOLD PRIOR WITHDRAWN